

1. Product Top View

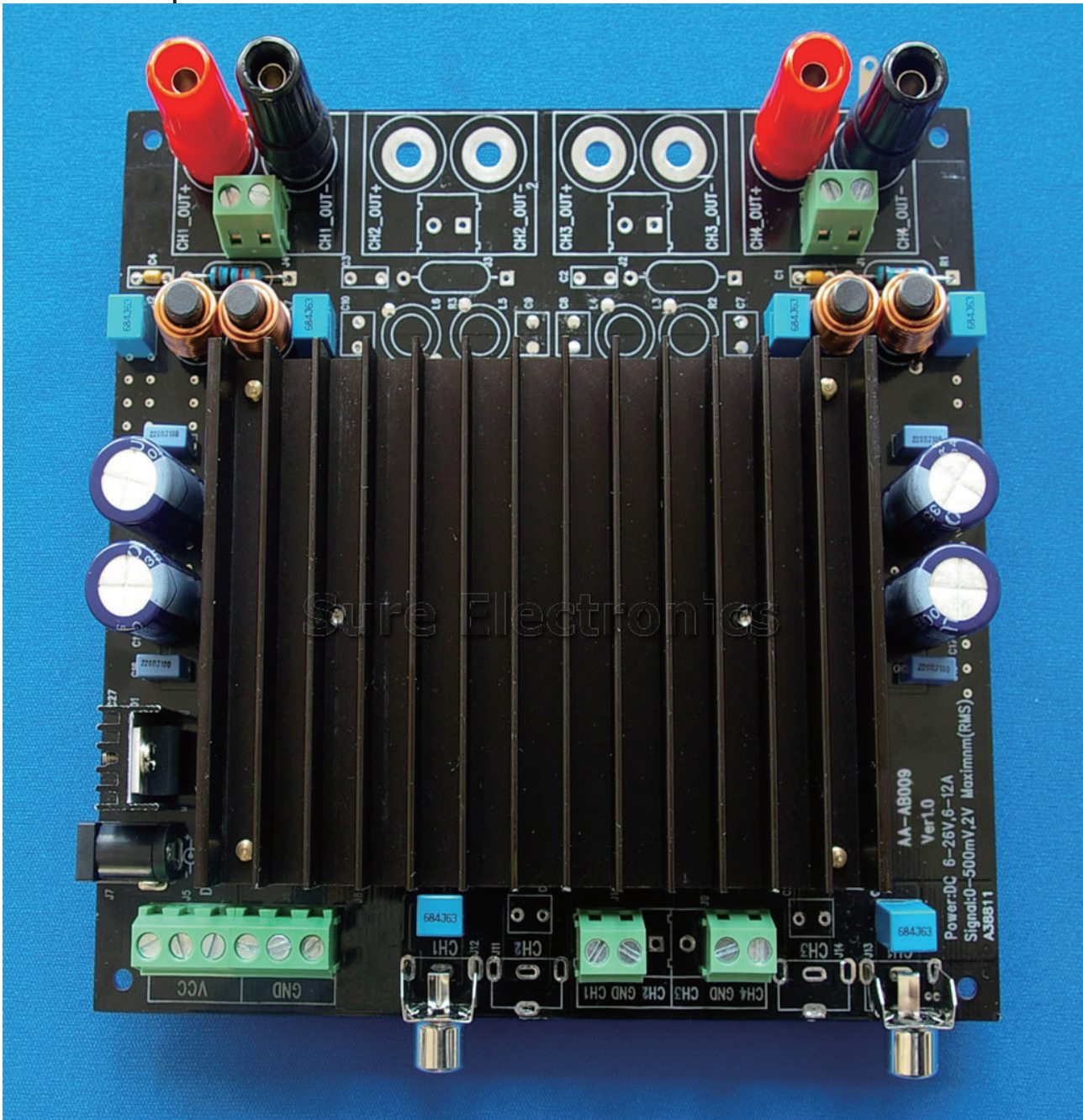

Figure 1

2. Electrical Characteristics

- All Audio Amplifier Boards had been tested for over 12 hours before shipping.
- 2CH D Class AMP
- 75W 2CH (THD 1% 4Ω)
- 150W 2CH – 2Ω
- Full bridge output
- 1 Input power
- Free Voltage (6V ~ 26V)
- Protection (thermal, over load)
- Analog signal input

- High Power efficiency up to 90% (2CH OUT at 30W)
- Operating Environment Temperature Range: 0~+55°C
- Storage Environment Temperature Range:-25~+85°C.

3. Physical Dimension

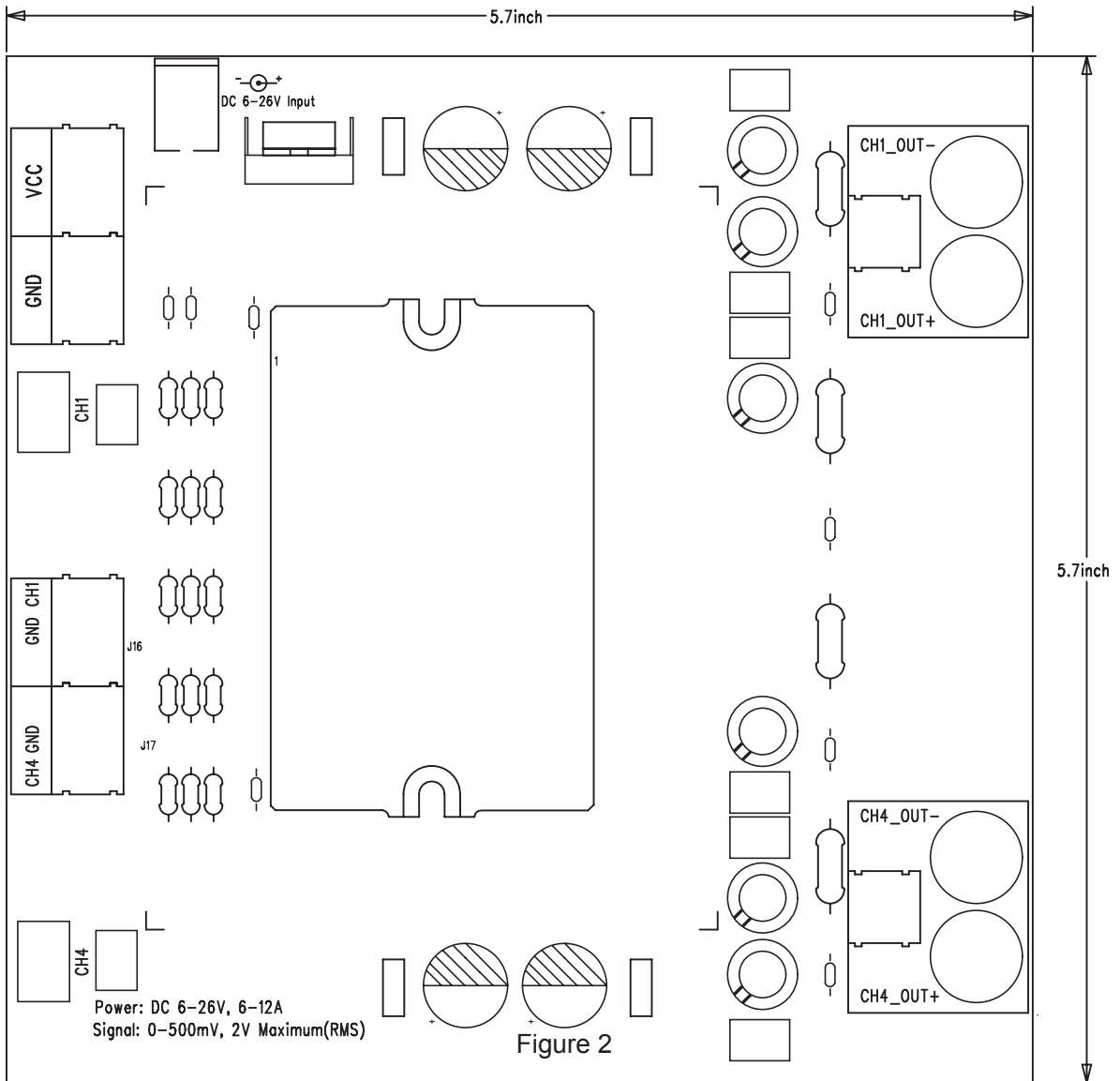

4. How to Connect Load

Suggested connection is shown in Figure 2.

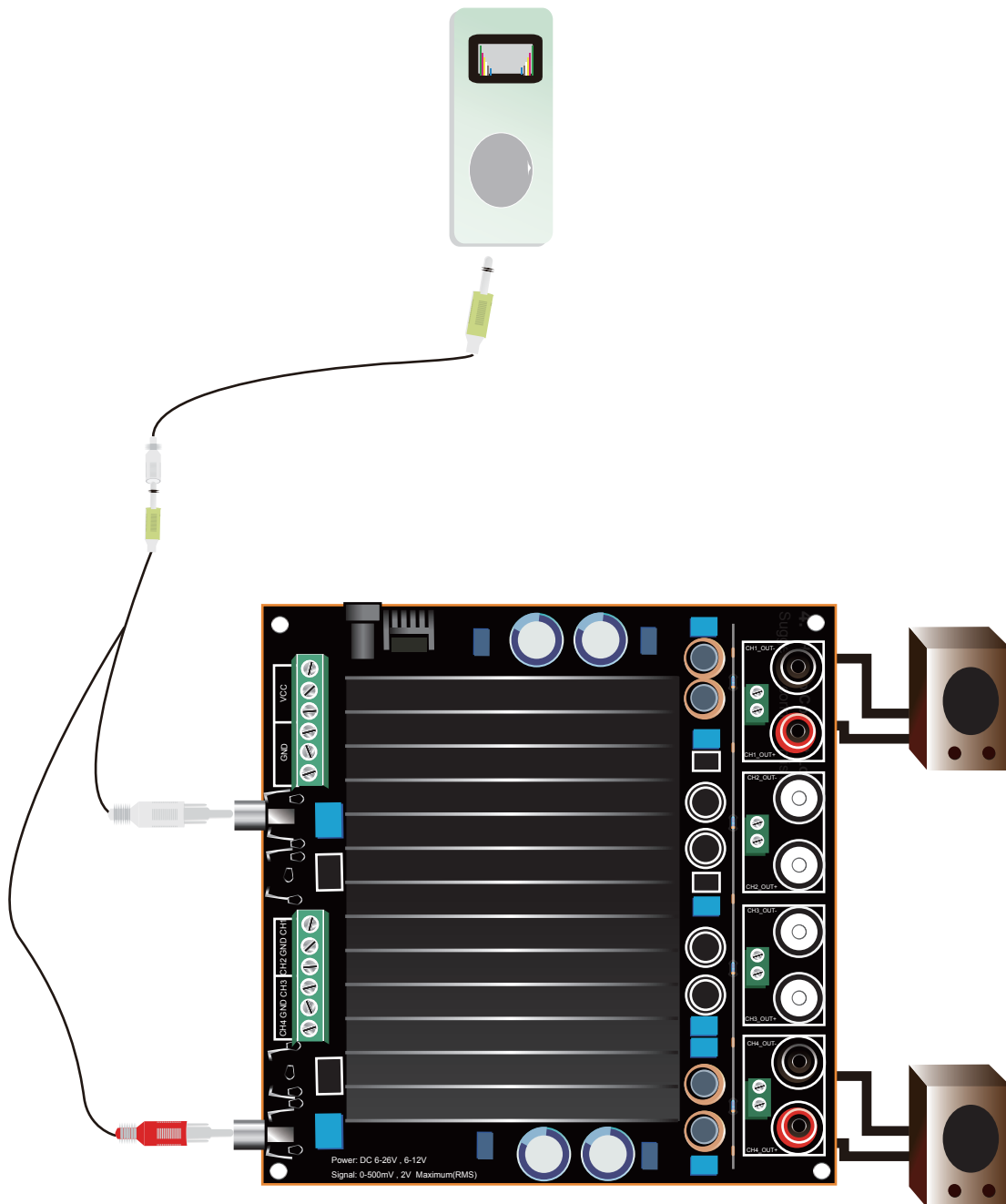

Figure 3 (View from capacitance installation side)

Notice:

1. GND should be connected to GND or the housing of your instrument.
2. There are two audio-input methods. One is via audio input. Another is via terminals (J9, J10).
3. There are two audio-output methods. One is via terminals (J1, J4). Another is via corresponding banana jack.

Contact Us

Sure Electronics Co., Ltd.

Floor 5, A zone,
Qinhuai Technology Innovation center,
NO.105-2, DaMing Road,
Nanjing,
China

Tel: +8613601408832
+86-25-66606340
(English service, from GMT1-10AM, only for technical questions)

Email: support@sure-electronics.net

Website: www.sure-electronics.net
www.sure-electronics.com
www.sureelectronics.net